

# icaros<sup>®</sup> 2

XI series

Led

Instructions de montage  
Mounting instructions  
Montageanleitung  
Montagehandleiding

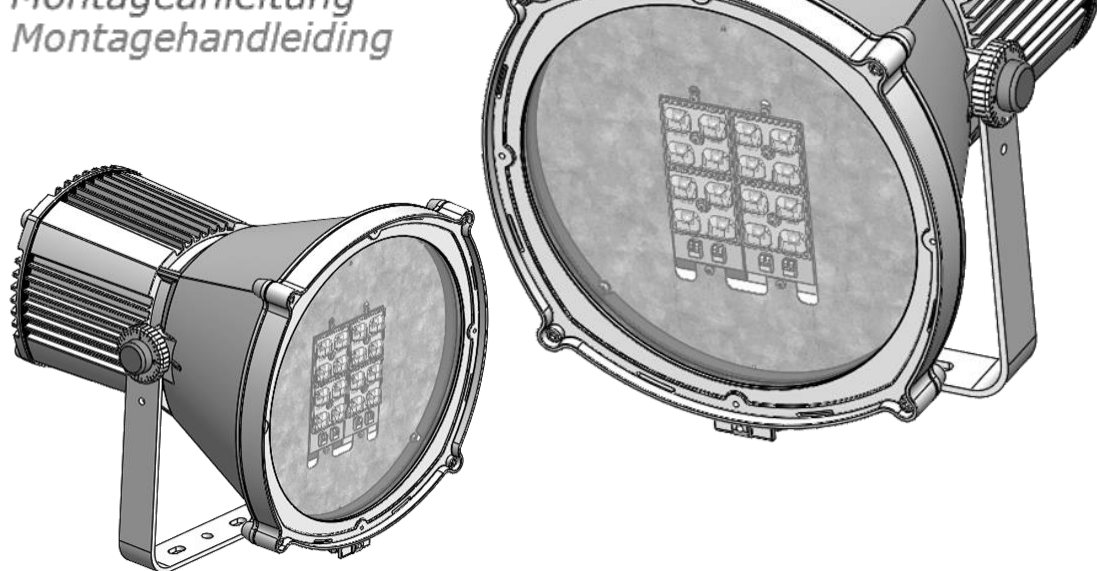

Type	LEDs	Power (W)	SCx (m <sup>2</sup> )	Weight (kg)
P-651	16	32	0.09	7.00
P-651	32	64	0.09	7.80

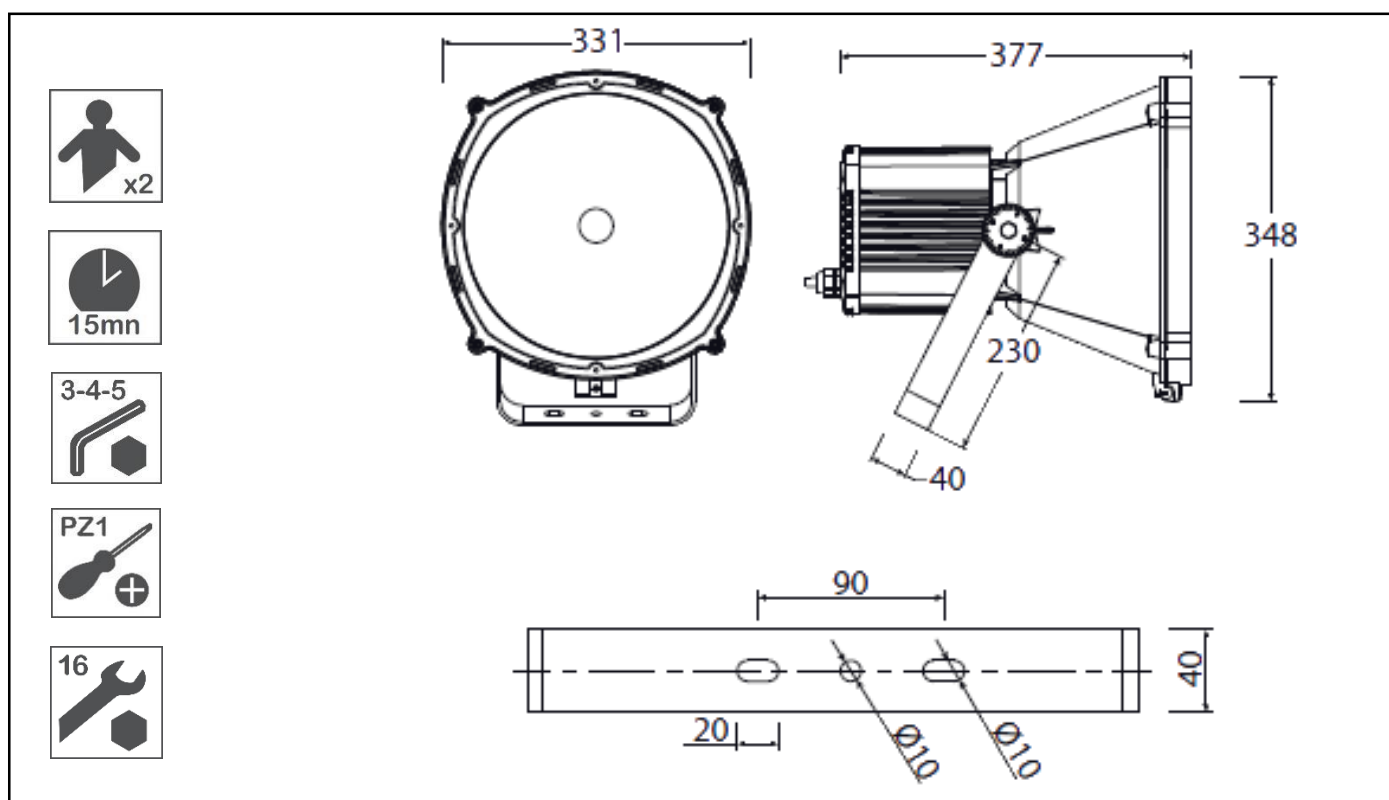



**P-651**

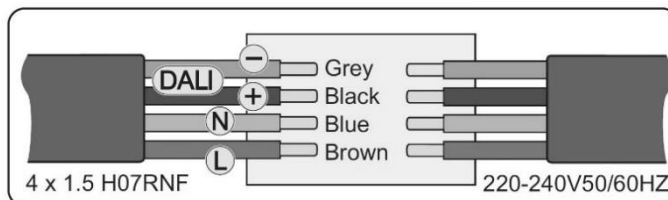

Disconnect before servicing  
Mettre hors tension avant intervention  
Offnen nur spannungsfrei  
Bij werkzaamheden aan de apparatuur

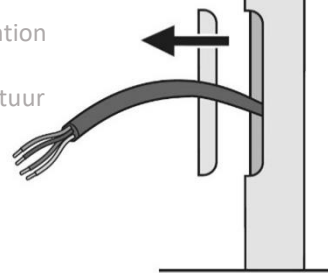

**1**

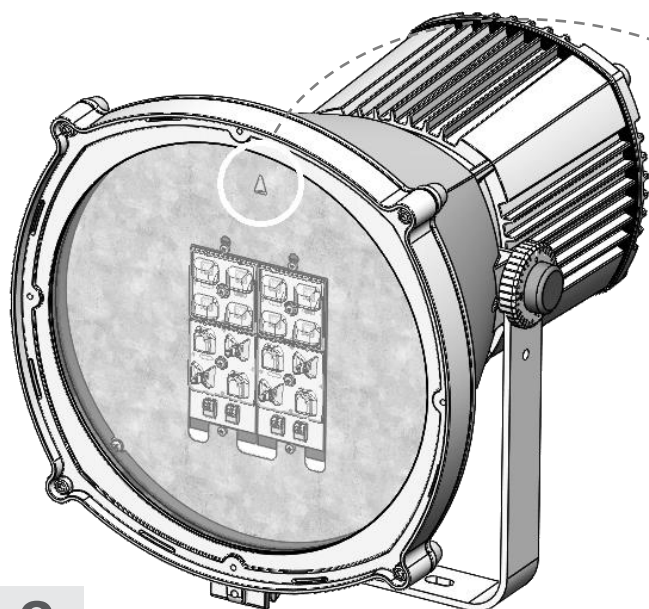

**2**

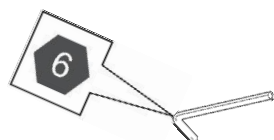
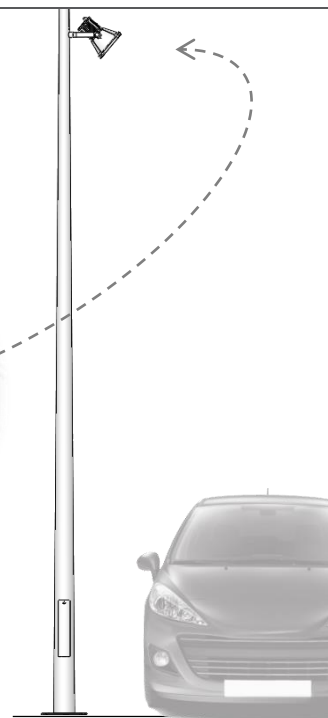

**25 Nm**

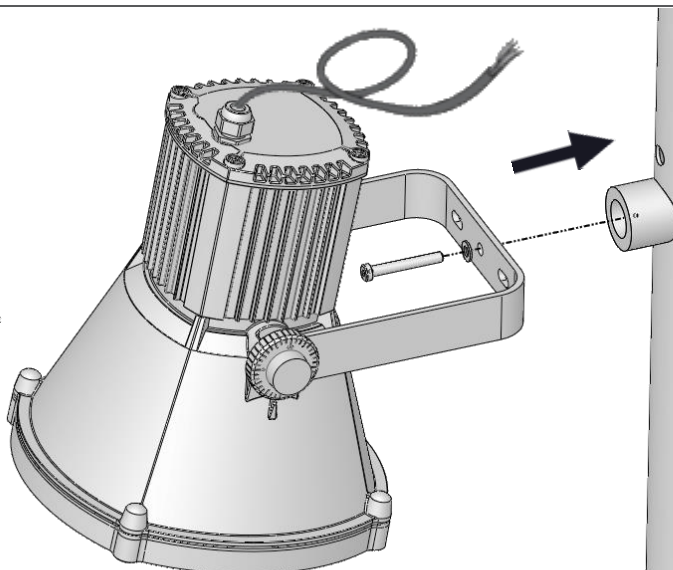

**3**



**P-651**

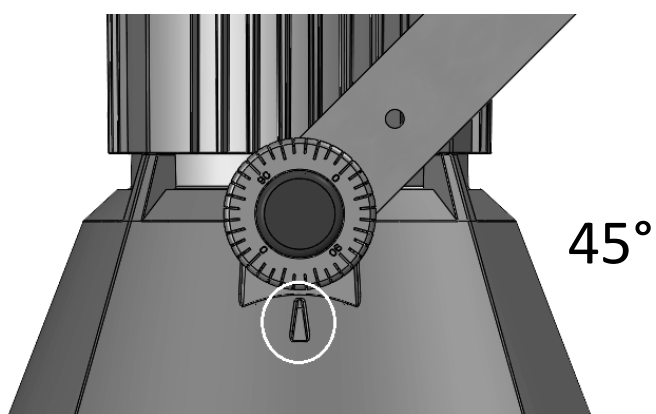
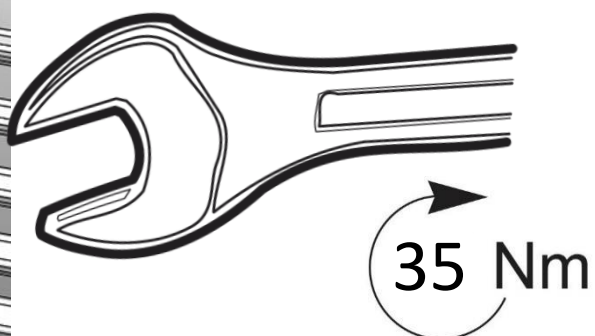
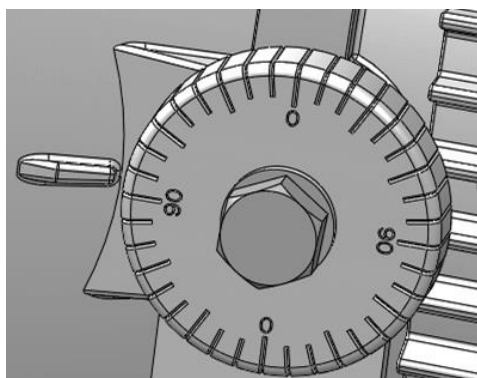
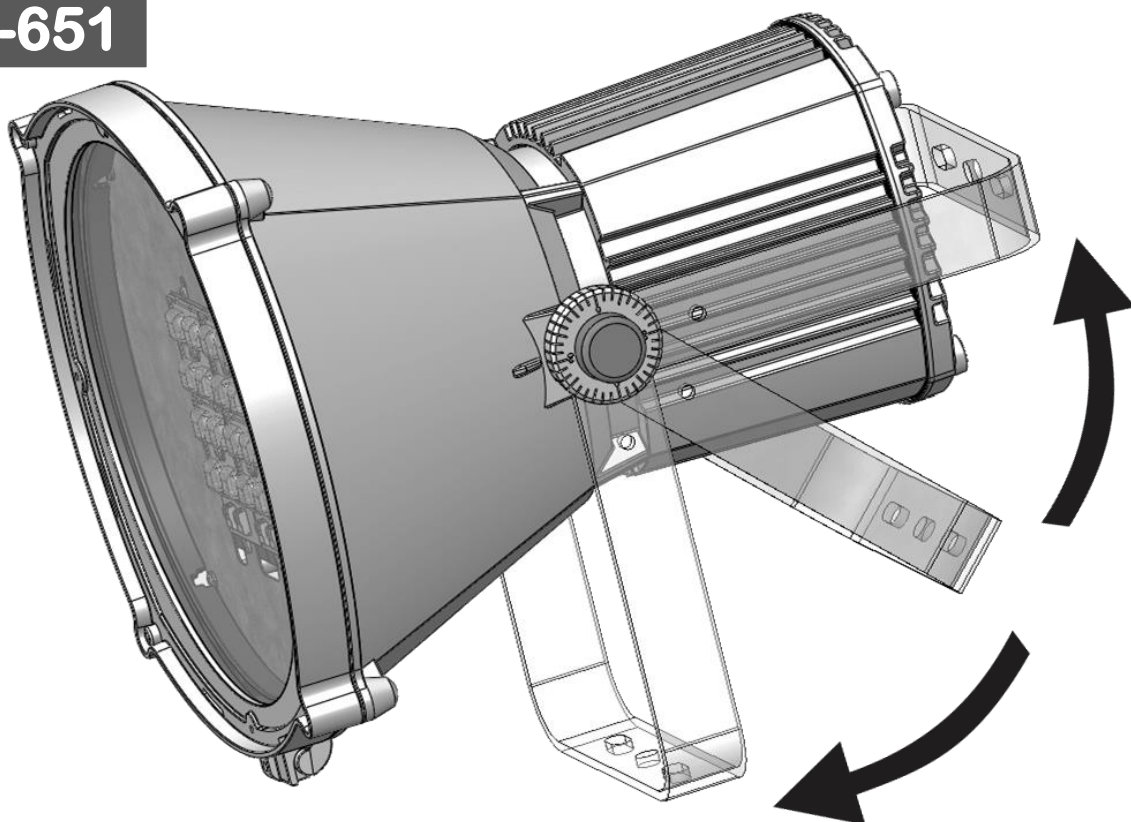

45°

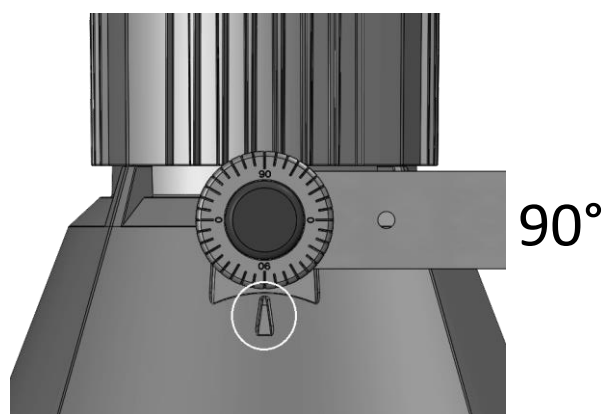

90°

**1**





**P-651**

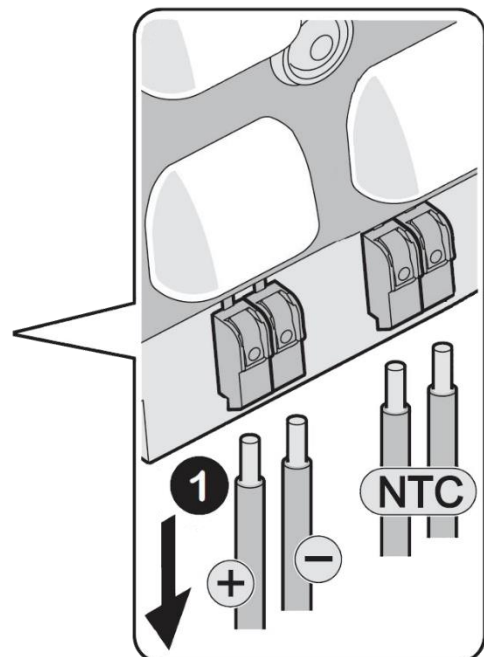
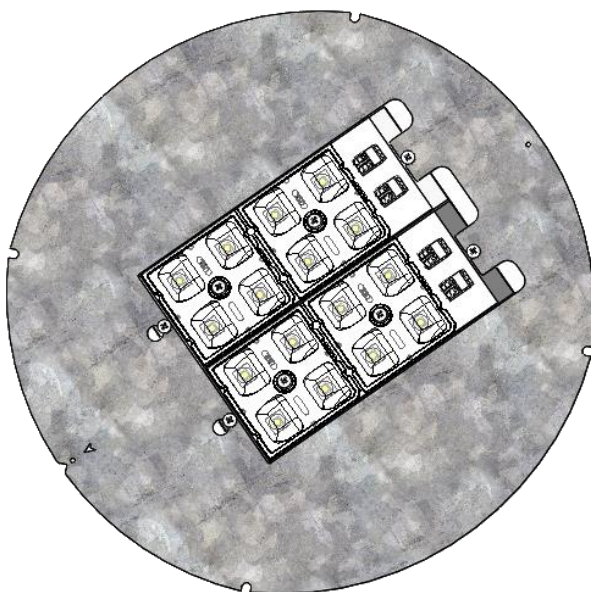
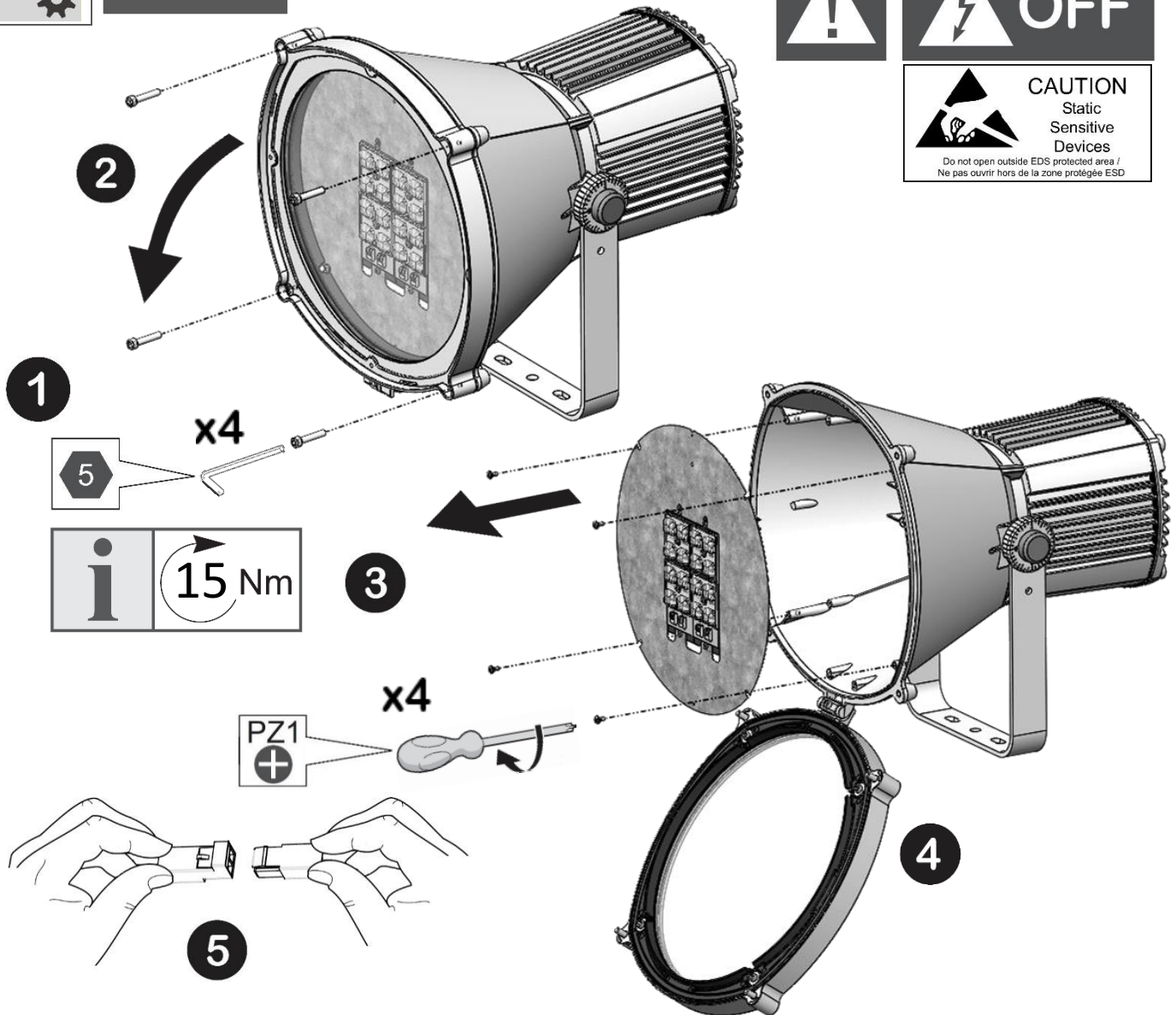



**P-651**

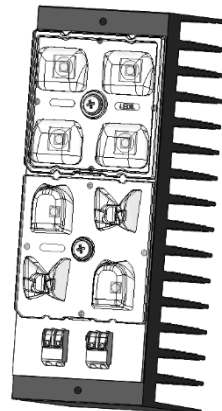
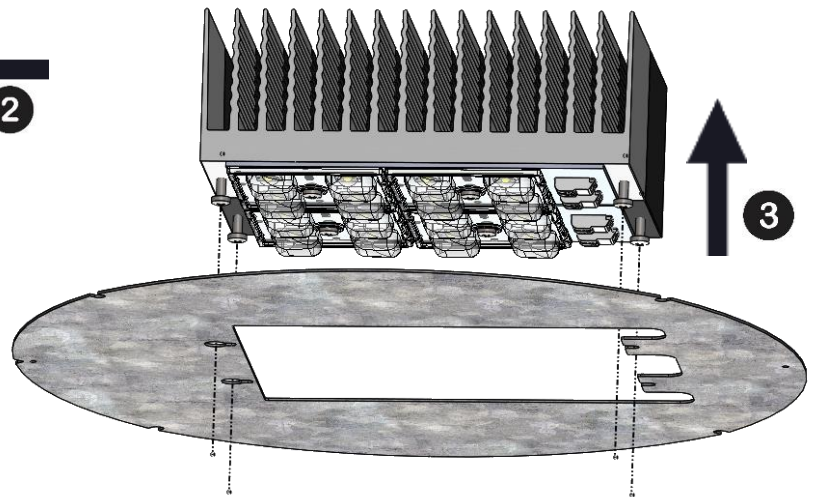
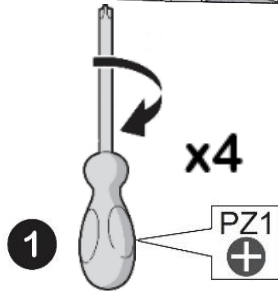
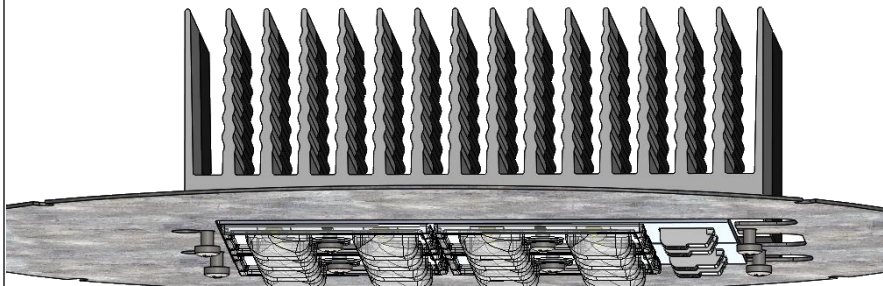

**64w**

2xmodule 2x8  
32 LEDs  
12 x CHC M4

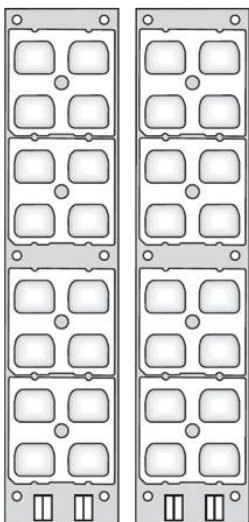

**32w LR**

1xmodule 4x4  
16 LEDs  
8x CHC M4

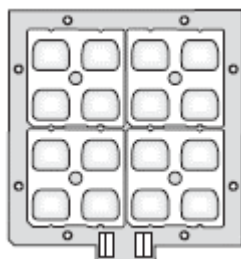

**32w LU**

2xmodule 2x4  
16 LEDs  
4x CBZ M3

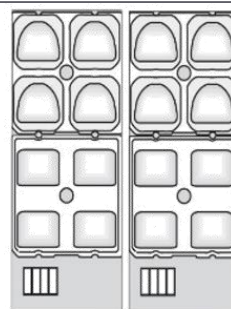

**64w**

2xmodule 2x8  
32 LEDs  
8x CBZ M3

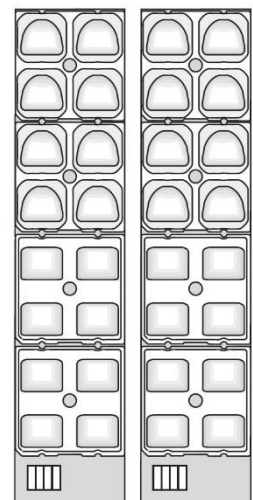



**P-651**



**CAUTION**  
Static  
Sensitive  
Devices

Do not open outside ESD protected area /  
Ne pas ouvrir hors de la zone protégée ESD

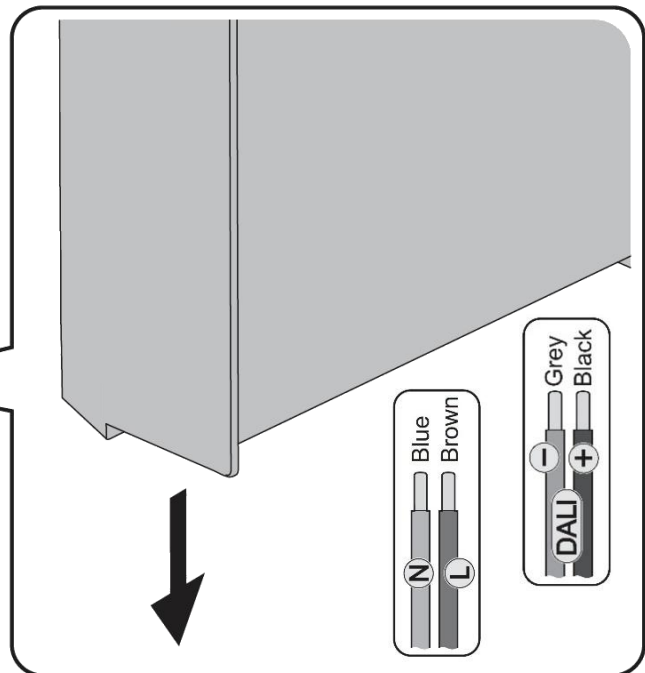
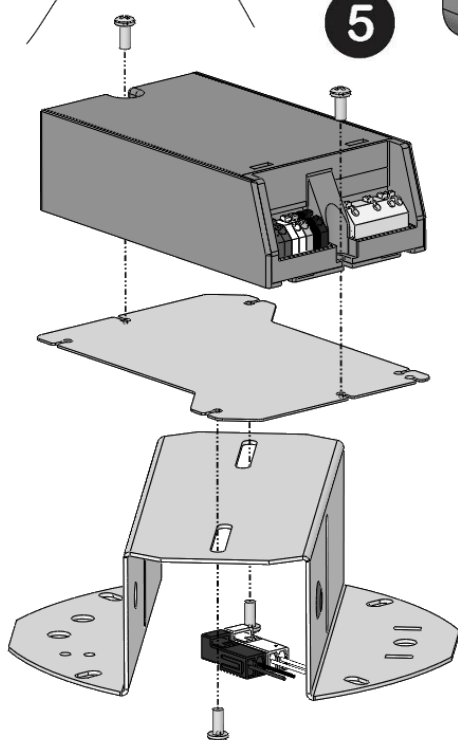
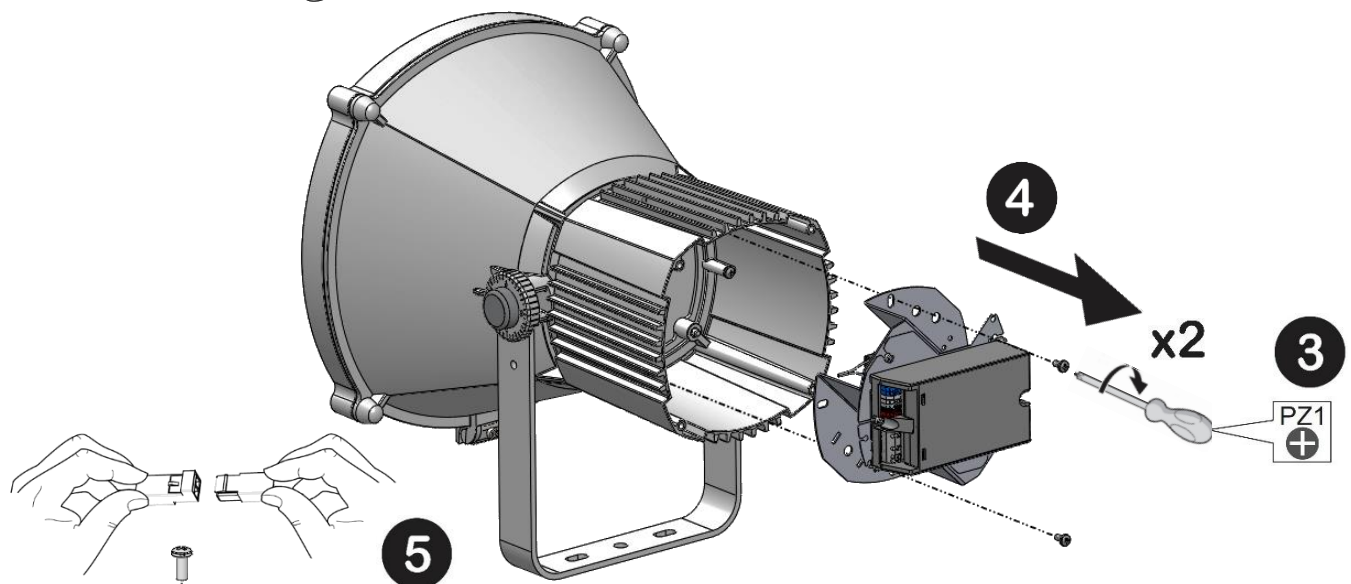
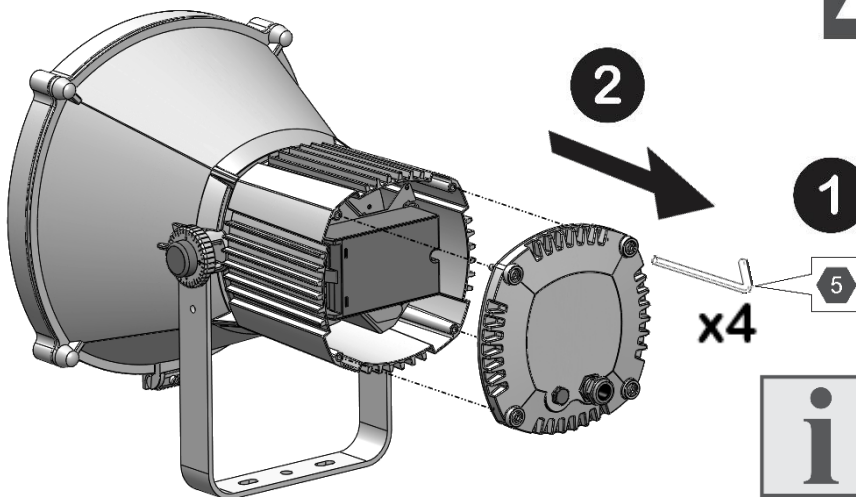



## P-651-Z-GP-I-B

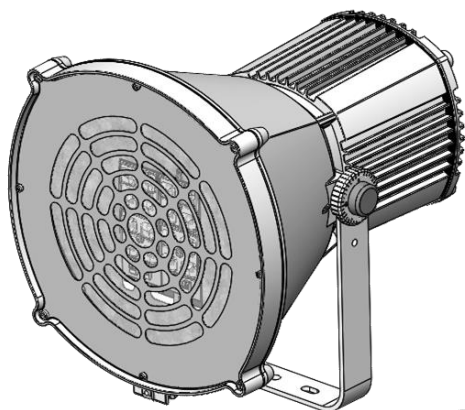

A1

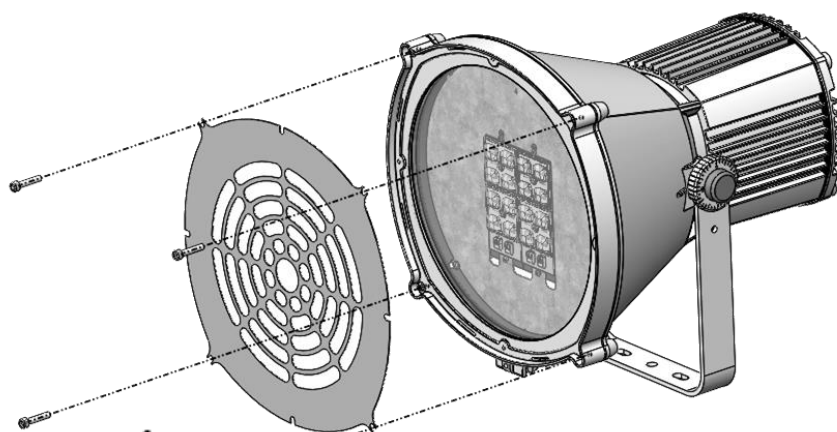

x4



## P-651-Z-GD-I-B

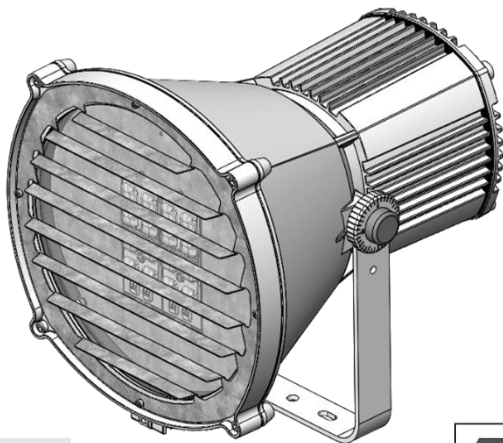

A2

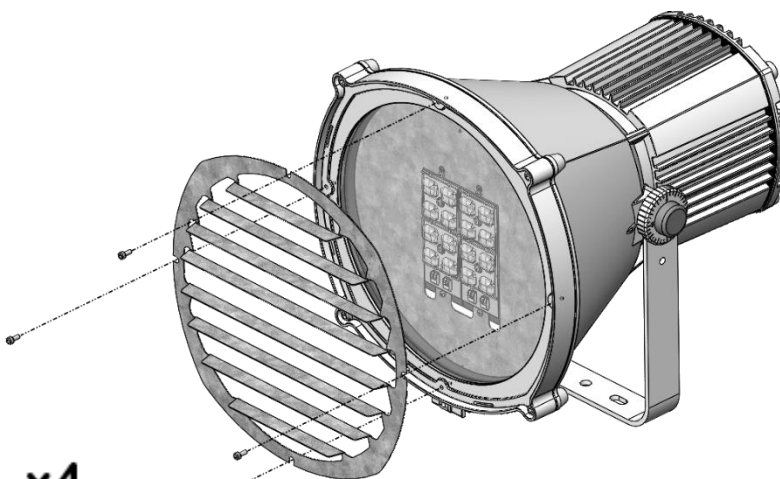

x4



## P-651-Z-SH-A-B

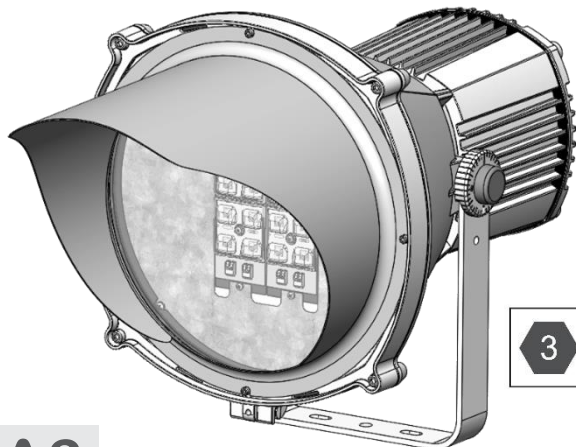

A3

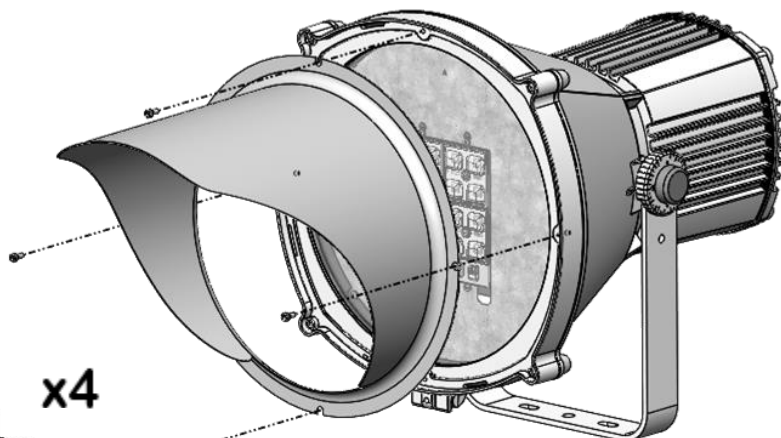

x4





**FRA**

La source de lumière intégrée dans ce luminaire peut uniquement être remplacée par un employé de Rohl, un agent ou une autre personne qualifiée.

Le câble d'alimentation (4x1,5 H07RNF) de ce luminaire (Y) ne peut être remplacé que par une personne qualifiée.

Il convient que le luminaire soit positionné de telle manière que le regard prolongé du luminaire à une distance <1m ne soit pas attendu.

**ENG**

The light source fitted in this luminaire shall only be replaced by a Rohl employee or agent or a similar qualified person.

The external flexible cable (4x1,5 H07RNF) of this luminaire (Y) shall only be replaced by a qualified person.

The luminaire with clear optic should be positioned so that prolonged staring into the luminaire at a distance <1m is not expected.

**GER**

Die eingebaute Lichtquelle in der Leuchte (Y) sollte nur von einem Rohl Mitarbeiter oder Vertreter oder einer ähnlichen qualifizierten Personen ersetzt werden.

Der Stromkabel (4x1,5 H07RNF) der Leuchte (Y) darf nur von einer qualifizierte Person ersetzt werden.

Die Leuchte mit klarer Optik sollte so positioniert werden, dass ein längerer Blick in die Leuchte in einem Abstand <1 m nicht zu erwarten ist.

**NLD**

De lichtbron in dit verlichtingstoestel mag alleen vervangen worden door een medewerker van Rohl, agent of een gekwalificeerd persoon.

De stroomkabel (4x1,5 H07RNF) van dit toestel mag alleen vervangen worden door een gekwalificeerd persoon.

Om te vermijden dat iemand lang en rechtstreeks in het verlichtingstoestel zou kijken, wordt aangeraden om het te installeren op een bepaalde manier, zeker indien het zich op een afstand van minder dan 1 m bevindt.

1



ROHL S.A.S

1 Rue de Bruxelles, BP 50048

F 67151 ERSTEIN Cedex

Tél: +33(0)3 90 29 90 70 / Fax: +33(0)3 90 29 90 71



[www.rohl.com](http://www.rohl.com)

